

NOTES

1. THIS DRAWING IS COPYRIGHT.
2. THE CONTRACTOR AND HIS SUBCONTRACTOR ARE TO VERIFY ALL DIMENSIONS ON SITE PRIOR TO MAKING STOP DRAWINGS OR COMMENCING MANUFACTURE.
3. DO NOT SCALE THIS DRAWING. THE CONTRACTOR IS TO BRING TO THE NOTICE OF THE ENGINEER ANY DISCREPANCIES CONTAINED IN THIS DRAWING PRIOR TO WORK COMMENCEMENT.
4. THIS DRAWING IS TO BE READ IN CONJUNCTION WITH ALL RELEVANT ARCHITECTS, ENGINEERS AND SPECIALIST SUB-CONTRACTORS DRAWINGS AND THE SPECIFICATION.
5. ALL SETTING OUT TO BE IN ACCORDANCE WITH THE ARCHITECTS DRAWINGS. ANY DISCREPANCIES BETWEEN THE ENGINEERS AND THE ARCHITECTS DRAWINGS TO BE REFERRED TO THE ARCHITECT BEFORE PROCEEDING. DIMENSIONS MUST NOT BE SCALED.

HEALTH & SAFETY:

ALL WORKS TO BE CARRIED OUT BY A CONTRACTOR COMPETENT TO UNDERTAKE THE CONSTRUCTION OF WORKS AS INDICATED ON THIS DRAWING. THIS DRAWING IS TO BE READ IN CONJUNCTION WITH THE JOB SPECIFIC RISK ASSESSMENT. THE HAZARDS NOTED ARE IN ADDITION TO THE NORMAL HAZARDS AND RISKS FACED BY A COMPETENT CONTRACTOR WHEN DEALING WITH THE TYPE OF WORKS DETAILED ON THIS DRAWING.

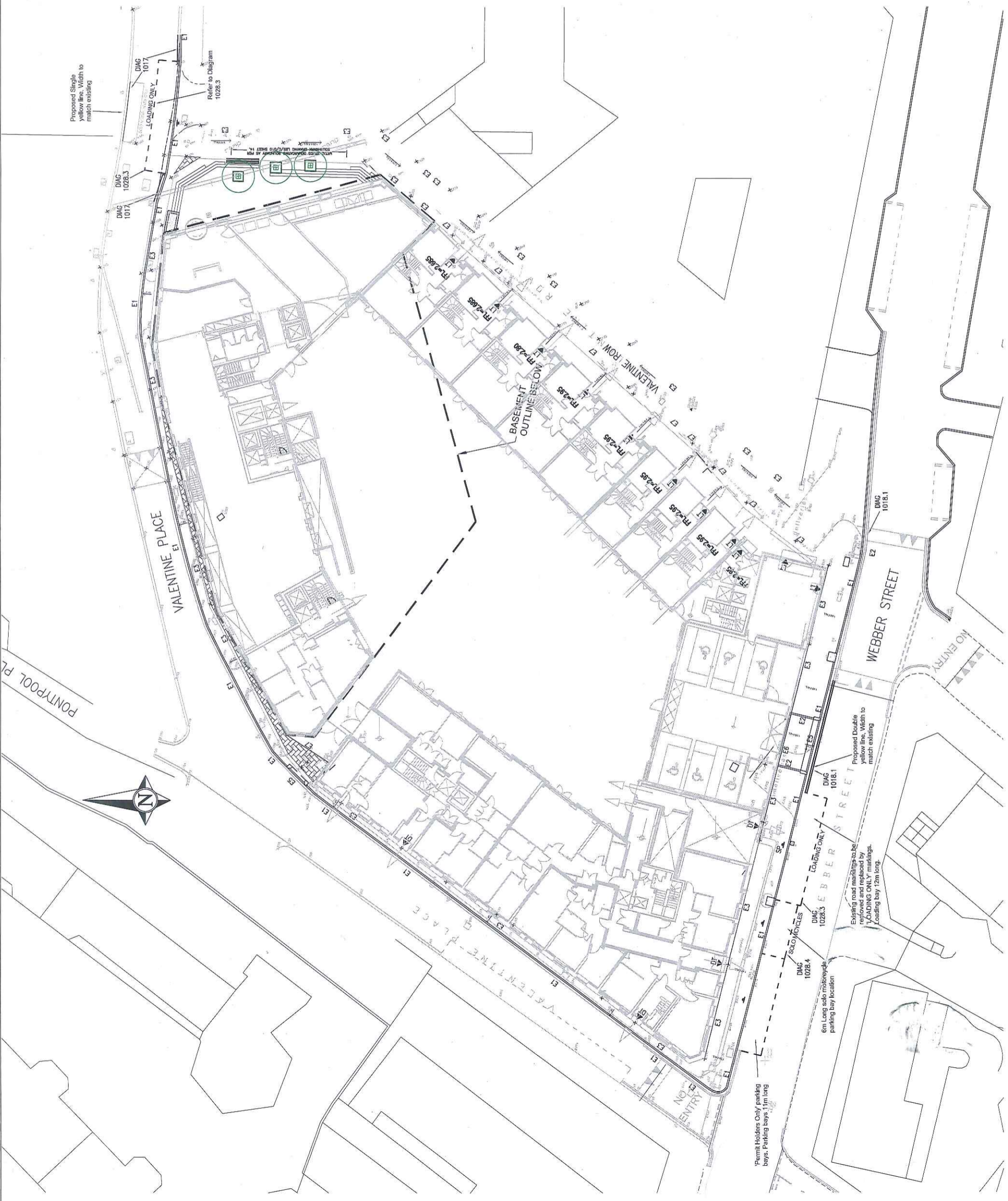

EXISTING REMOVED TO PARKING REF
 P1 AMENDED TO SCC COMMENTS 20.04.16
 P2 AMENDED TO SCC COMMENTS 20.04.16
 P3 AMENDED TO SCC COMMENTS 06.10.15
 P4 AMENDED TO SCC COMMENTS 06.10.15
 P5 AMENDED TO SCC COMMENTS 06.10.15
 P6 AMENDED TO SCC COMMENTS 06.10.15
 P7 AMENDED TO SCC COMMENTS 06.10.15
 P8 AMENDED TO SCC COMMENTS 06.10.15
 P9 AMENDED TO SCC COMMENTS 06.10.15
 P10 AMENDED TO SCC COMMENTS 06.10.15
 P11 AMENDED TO SCC COMMENTS 06.10.15
 P12 AMENDED TO SCC COMMENTS 06.10.15
 P13 AMENDED TO SCC COMMENTS 06.10.15
 P14 AMENDED TO SCC COMMENTS 06.10.15
 P15 AMENDED TO SCC COMMENTS 06.10.15
 P16 AMENDED TO SCC COMMENTS 06.10.15
 P17 AMENDED TO SCC COMMENTS 06.10.15
 P18 AMENDED TO SCC COMMENTS 06.10.15
 P19 AMENDED TO SCC COMMENTS 06.10.15
 P20 AMENDED TO SCC COMMENTS 06.10.15
 P21 AMENDED TO SCC COMMENTS 06.10.15
 P22 AMENDED TO SCC COMMENTS 06.10.15
 P23 AMENDED TO SCC COMMENTS 06.10.15
 P24 AMENDED TO SCC COMMENTS 06.10.15
 P25 AMENDED TO SCC COMMENTS 06.10.15
 P26 AMENDED TO SCC COMMENTS 06.10.15
 P27 AMENDED TO SCC COMMENTS 06.10.15
 P28 AMENDED TO SCC COMMENTS 06.10.15
 P29 AMENDED TO SCC COMMENTS 06.10.15
 P30 AMENDED TO SCC COMMENTS 06.10.15
 P31 AMENDED TO SCC COMMENTS 06.10.15
 P32 AMENDED TO SCC COMMENTS 06.10.15
 P33 AMENDED TO SCC COMMENTS 06.10.15
 P34 AMENDED TO SCC COMMENTS 06.10.15
 P35 AMENDED TO SCC COMMENTS 06.10.15
 P36 AMENDED TO SCC COMMENTS 06.10.15
 P37 AMENDED TO SCC COMMENTS 06.10.15
 P38 AMENDED TO SCC COMMENTS 06.10.15
 P39 AMENDED TO SCC COMMENTS 06.10.15
 P40 AMENDED TO SCC COMMENTS 06.10.15
 P41 AMENDED TO SCC COMMENTS 06.10.15
 P42 AMENDED TO SCC COMMENTS 06.10.15
 P43 AMENDED TO SCC COMMENTS 06.10.15
 P44 AMENDED TO SCC COMMENTS 06.10.15
 P45 AMENDED TO SCC COMMENTS 06.10.15
 P46 AMENDED TO SCC COMMENTS 06.10.15
 P47 AMENDED TO SCC COMMENTS 06.10.15
 P48 AMENDED TO SCC COMMENTS 06.10.15
 P49 AMENDED TO SCC COMMENTS 06.10.15
 P50 AMENDED TO SCC COMMENTS 06.10.15
 P51 AMENDED TO SCC COMMENTS 06.10.15
 P52 AMENDED TO SCC COMMENTS 06.10.15
 P53 AMENDED TO SCC COMMENTS 06.10.15
 P54 AMENDED TO SCC COMMENTS 06.10.15
 P55 AMENDED TO SCC COMMENTS 06.10.15
 P56 AMENDED TO SCC COMMENTS 06.10.15
 P57 AMENDED TO SCC COMMENTS 06.10.15
 P58 AMENDED TO SCC COMMENTS 06.10.15
 P59 AMENDED TO SCC COMMENTS 06.10.15
 P60 AMENDED TO SCC COMMENTS 06.10.15
 P61 AMENDED TO SCC COMMENTS 06.10.15
 P62 AMENDED TO SCC COMMENTS 06.10.15
 P63 AMENDED TO SCC COMMENTS 06.10.15
 P64 AMENDED TO SCC COMMENTS 06.10.15
 P65 AMENDED TO SCC COMMENTS 06.10.15
 P66 AMENDED TO SCC COMMENTS 06.10.15
 P67 AMENDED TO SCC COMMENTS 06.10.15
 P68 AMENDED TO SCC COMMENTS 06.10.15
 P69 AMENDED TO SCC COMMENTS 06.10.15
 P70 AMENDED TO SCC COMMENTS 06.10.15
 P71 AMENDED TO SCC COMMENTS 06.10.15
 P72 AMENDED TO SCC COMMENTS 06.10.15
 P73 AMENDED TO SCC COMMENTS 06.10.15
 P74 AMENDED TO SCC COMMENTS 06.10.15
 P75 AMENDED TO SCC COMMENTS 06.10.15
 P76 AMENDED TO SCC COMMENTS 06.10.15
 P77 AMENDED TO SCC COMMENTS 06.10.15
 P78 AMENDED TO SCC COMMENTS 06.10.15
 P79 AMENDED TO SCC COMMENTS 06.10.15
 P80 AMENDED TO SCC COMMENTS 06.10.15
 P81 AMENDED TO SCC COMMENTS 06.10.15
 P82 AMENDED TO SCC COMMENTS 06.10.15
 P83 AMENDED TO SCC COMMENTS 06.10.15
 P84 AMENDED TO SCC COMMENTS 06.10.15
 P85 AMENDED TO SCC COMMENTS 06.10.15
 P86 AMENDED TO SCC COMMENTS 06.10.15
 P87 AMENDED TO SCC COMMENTS 06.10.15
 P88 AMENDED TO SCC COMMENTS 06.10.15
 P89 AMENDED TO SCC COMMENTS 06.10.15
 P90 AMENDED TO SCC COMMENTS 06.10.15
 P91 AMENDED TO SCC COMMENTS 06.10.15
 P92 AMENDED TO SCC COMMENTS 06.10.15
 P93 AMENDED TO SCC COMMENTS 06.10.15
 P94 AMENDED TO SCC COMMENTS 06.10.15
 P95 AMENDED TO SCC COMMENTS 06.10.15
 P96 AMENDED TO SCC COMMENTS 06.10.15
 P97 AMENDED TO SCC COMMENTS 06.10.15
 P98 AMENDED TO SCC COMMENTS 06.10.15
 P99 AMENDED TO SCC COMMENTS 06.10.15
 P100 AMENDED TO SCC COMMENTS 06.10.15

INFORMATION

Crest
 7th Floor, New Fetter Lane
 8-10 New Fetter Lane
 London
 EC4A 1AZ
 Tel: 0203 640 7555
 Fax: 0203 640 7556
 www.crestmichelson.com

Address: VALENTINE PLACE
 City/Town: LONDON
 Scale: 1:200
 Date: 11 MAY 15
 Drawing No: 14499TA-3304
 Revision: P5